

SECTION V

RADIO AND COMPONENTS—DESCRIPTION

The radio receiver/tuner, speaker, and antenna as provided are shown as an installation in Figure V-3. Component R&R is in accordance with the following procedure.

A. Remove and Replace (Radio Receiver/Tuner)

1. For reasons of safety, disconnect the Positive (+) battery cable at the battery terminal.
2. Disconnect the radio chassis electrical circuit from the instrument panel wire harness (see Figure V-3, Detail "B") as follows:
 - a. Receiver-antenna lead-in, Item 12.
 - b. Main power source connector, Item 13.
 - c. Antenna motor power connector, Item 14.
3. Remove the two opposed rear radio chassis support screws. (See Figure V-1, Item 2.)
4. Remove the two Phillips head screws from the front of the radio tuner escutcheon. (See Figure V-2.)
5. Remove the ashtray assembly. Support the radio from underneath to avoid marring the floor console and pull the unit out of the center console finisher.
6. Replace the radio in the reverse order of this procedure. Connect the battery and verify proper working order of the receiver and power antenna.

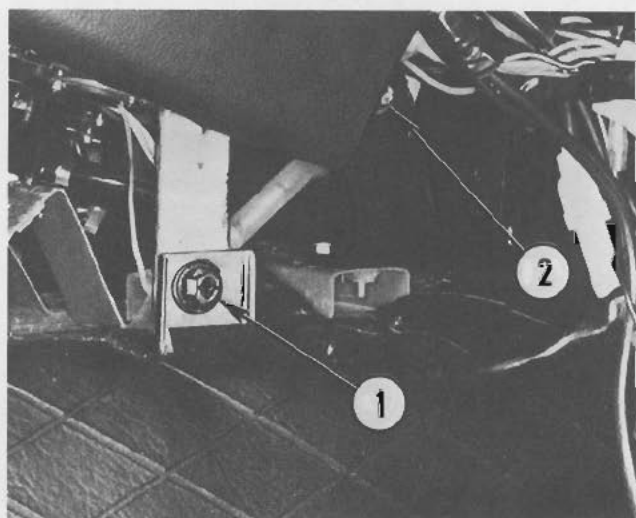

Figure V-1. Radio Chassis Rear Mount



Figure V-2. Radio Tuner Mounting Screws

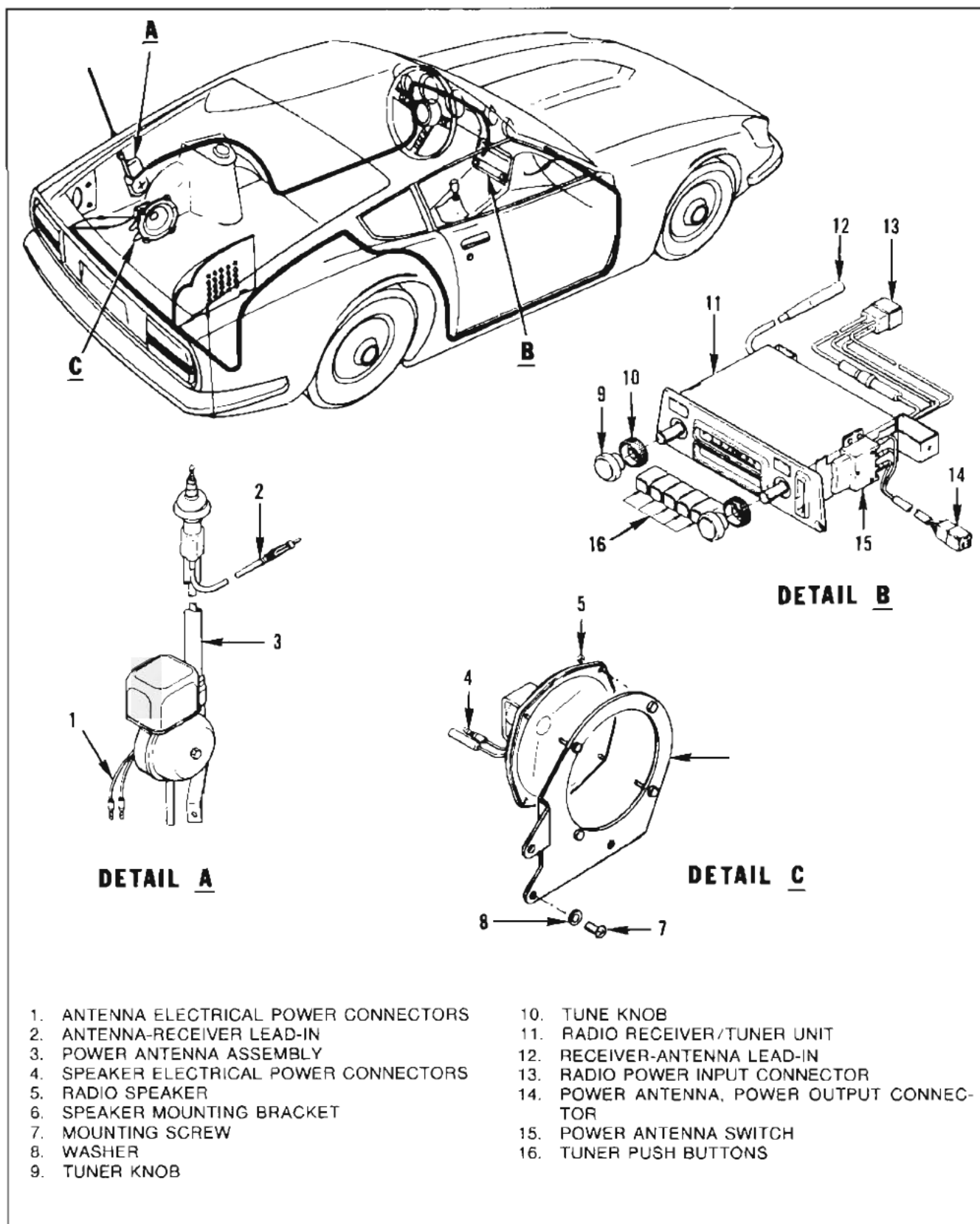
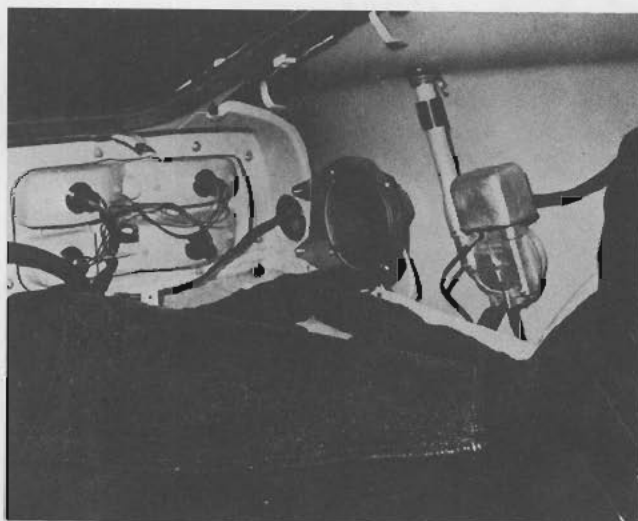

Figure V-3. Radio installation and Components

B. Remove and Replace (Radio Speaker and Power Antenna)

1. The radio speaker and antenna unit are mounted in the rear left-hand fender void between the fender and the inner rear side trim panel. (See Figures V-3 and V-4.)



*Figure V-4. Speaker and Antenna Installation
(Interior Trim Panels Removed)*

2. Both the rear and side trim panel must be removed to gain access to the speaker and antenna; and in that order.

3. The trim panels are held in place with plastic rivets which can be removed by piercing with an awl and withdrawing when friction is obtained. The rivets are expendable and not intended for reuse.

4. Remove the radio speaker mounting bracket integral with speaker attached by first disconnecting the electrical connectors, as shown in Figure V-3, Detail "C."

5. Remove the three speaker bracket mounting screws (see Figure V-5), and lift the assembly from position.

a. The speaker is secured to the bracket mounting studs with four nuts and lock-washers.

b. Remove and replace a defective speaker with (Part No. 29240-E 4125) kit-speaker.

6. To remove the power antenna unit, first fully retract (lower) the antenna rod into the retracting body. From outside, remove the gland nut from

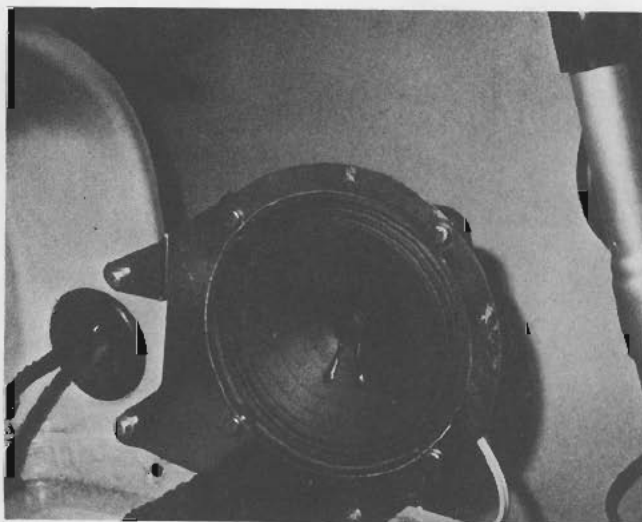

Figure V-5. Speaker and Bracket Installed

the antenna base at the fender thru-hole. Proceed from inside the vehicle as follows:

a. Disconnect the antenna electrical power connector and antenna lead. (See Figure V-3, Detail "C.")

b. Locate the wing nut at the lower end of the antenna body mounting bracket and remove it from the body stud.

c. Lower the antenna unit out of the fender thru-hole. Replace a defective unit with (Part No. 27350-E 4125) kit-automatic aerial.

7. Replacement of the radio speaker and antenna unit is in the reverse order of this procedure. Remember to replace the rear side trim panel first upon reassembly and to install trim panels with new plastic rivets. A check for proper operation of components should be made prior to replacing trim panels.

NOTES